

Agilent Technologies

Innovating the HP Way

Chemical Analysis Group

1100 Series Liquid Chromatograph

1100 Series Autosampler - Changing Valve Rotor Seal

Document 25303

Rotor Seal

Frequency	Poor injection-volume reproducibility Leaking injection valve
Tools required	1/4 inch wrench (supplied in accessory kit). Hex key, 9/64 inch (supplied in accessory kit).
Parts required	Rotor seal, 0100-1853 (Vespel), 0100-1849 (Tefzel).

CAUTION The stator face is held in place by the stator head. When removing the stator head, ensure the stator face does not fall out of the valve.

Before beginning this procedure:

- 1 Remove the front cover.

- 1 Remove all capillary fittings from the injection-valve ports.

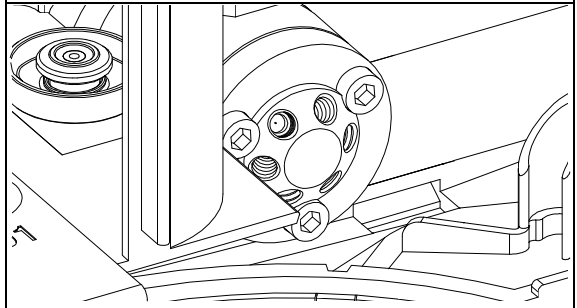

- 2 Loosen each fixing bolt two turns at a time. Remove the bolts from the head.

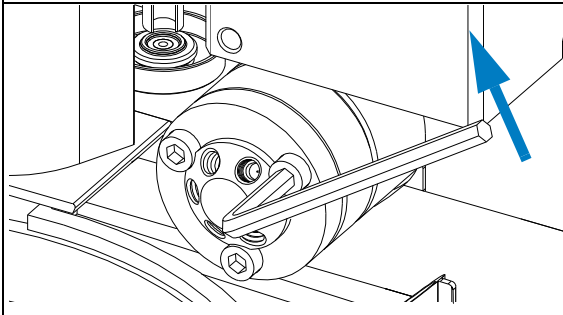

- 3 Remove the stator head, stator face and stator ring.

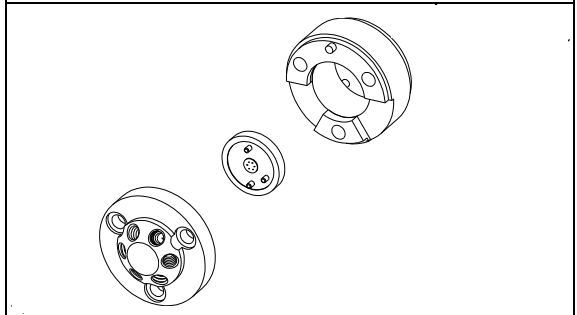

Rotor Seal

- 4** Remove the rotor seal (and isolation seal if required)

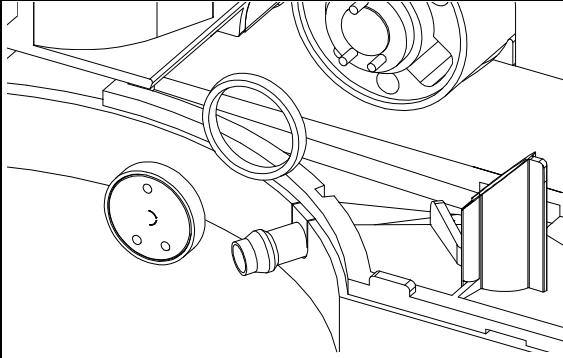

- 5** Install the new rotor seal and isolation seal (if required). Ensure the metal spring inside the isolation seal faces towards the valve body.

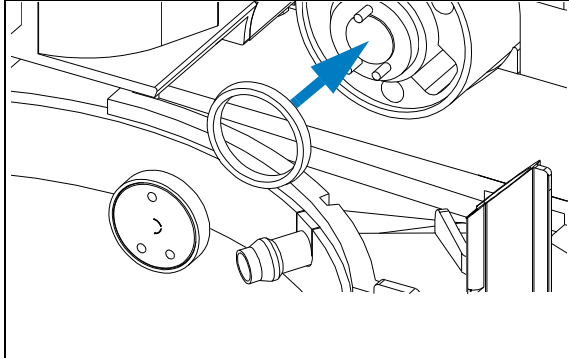

- 6** Install the stator ring. Ensure the housing is flush against the valve body.

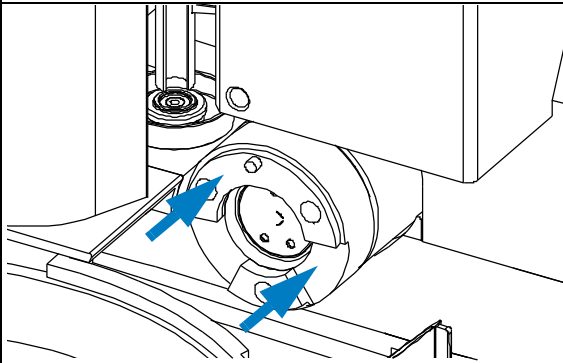

- 7** Place the stator face in place on the stator head.

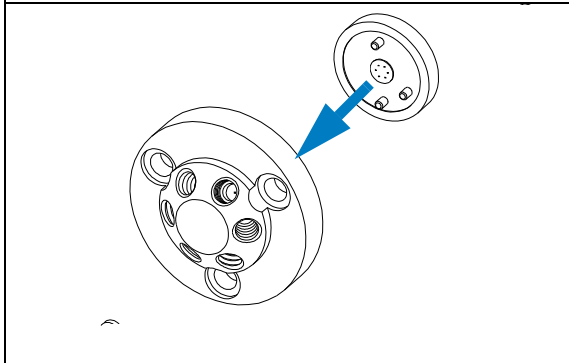

Repairing the Autosampler

Rotor Seal

- 8** Install stator head and stator face. Tighten the bolts alternately two turns at a time until the stator head is secure.

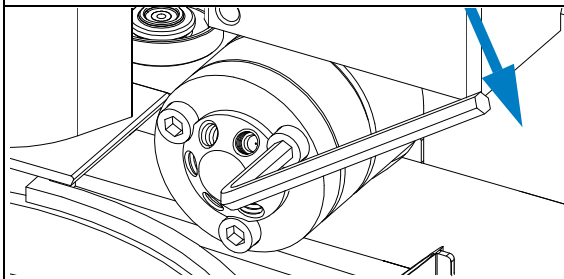

- 9** Reconnect the pump capillaries to the valve ports (see “Flow Connections” on page 22).

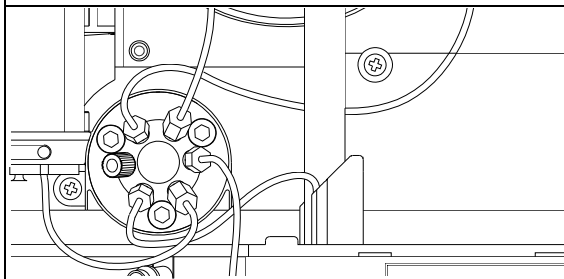

- 10** Slide the waste tube into the waste holder in the leak tray.

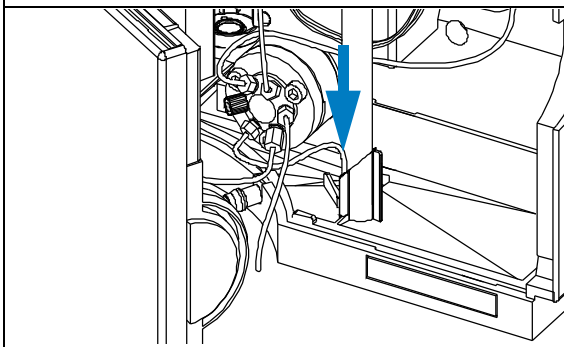

On completion of this procedure:

- 1** Install the front cover.