



Agilent InfinityLab LC Series

1290 Infinity II

Preparative Column Compartment

User Manual

This manual contains information about the installation of the InfinityLab LC Series 1290 Infinity II Preparative Column Compartment (G7163B).

Contents

Introduction 2

Product Description 2

Features 3

Overview 3

Specifications 4

Physical Specifications 4

Performance Specifications 5

Installation 6

Delivery Checklist 6

Accessory Kit 6

Leak and Waste 7

Install the Equipotential Cable 8

Install the Holder S (small) 9

Install the Holder M (medium) and Clamp Assembly 10

Install the Holder L (large) 11

Install Valves 12



Agilent Technologies

Introduction

Product Description

The 1290 Infinity II Preparative Column Compartment gives you the highest flexibility for mounting and organization of your analytical and preparative columns, valves, delay coils and MS Flow Modulator – all within a single module. Up to four analytical columns and six preparative columns can be mounted inside the module. Five slots are available for mounting of valves.



Figure 1 1290 Infinity II Preparative Column Compartment

Features

- Greater flexibility in organization of solvent selection valves, fraction delay coils, and MS Flow Modulator for a significant increase in productivity
- Convenient modular design that fits to any InfinityLab LC Purification Solution
- Five multipurpose slots
- Mounting of analytical-scale and preparative-scale columns
- Saves valuable bench space in your laboratory
- Provides safety features such as leak sensor

Overview

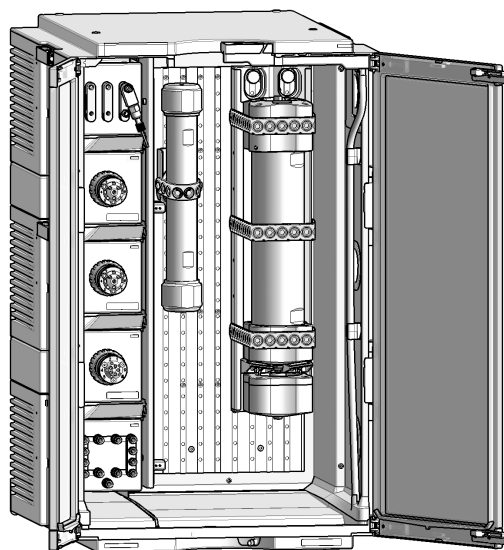

Figure 2 Overview of the Preparative Column Compartment

Specifications

Physical Specifications

Table 1 Physical Specifications

Type	Specification	Comment
Weight	22.7 kg (50 lbs)	
Dimensions (width x height x depth)	396 x 640 x 436 mm (15.6 x 25.2 x 17.2 inches)	
Ambient operating temperature	4 – 40 °C (39 – 104 °F)	See specification of the modules used with the 1290 Infinity II Preparative Column Compartment
Ambient non- operating temperature	-40 – 70 °C (-40 – 158 °F)	
Humidity	<95 % r.h. at 40 °C (104 °F)	Non-condensing See specification of the modules used with the 1290 Infinity II Preparative Column Compartment
Operating altitude	Up to 3000 m (9842 ft)	See specification of the modules used with the 1290 Infinity II Preparative Column Compartment
Non-operating altitude	Up to 4600 m (15092 ft)	For storing the module
Safety standards: IEC, EN, CSA, UL	Installation category see specification of the modules used with the Column Compartment Pollution degree 2	For indoor use only

Performance Specifications

Table 2 Performance Specifications

Type	Specification	Comment
External Leak Sensor	Yes	Via 2.5 mm connector
Multi-purpose Slots	5 x	Suitable for: <ul style="list-style-type: none"> • 1290 Infinity II MS Flow Modulator • 1260 Infinity II Delay Coil Organizer • 1260 Infinity II Valve-based Fraction Collector (both as Fraction Collector as well as Recovery Collector) • 1290 Infinity Valve Drive with any Agilent valve head
Preparative Columns	max. 6	
Analytical Columns	max. 4	
Manual Injector	Can be mounted inside	
Maintenance and safety-related features	Leak handling with external leak sensor and leak pane. Leak detection, safe leak handling, leak output signal for shutdown of pumping system. Exhaust tube adapter for connection to the laboratory venting system with a minimum flow of 6 L/s or 21.6 m³/h.	
Housing	All materials recyclable	

Installation

Delivery Checklist

p/n	Description
G7163-64000	Agilent InfinityLab LC Series 1290 Infinity II Preparative Column Compartment
G7163-68755	Accessory Kit
G7116-68300	Column Holder Lamella 2/PK for Inf. II
5067-6849	Column Holder Kit M
G7163-60002	Column Holder L

Accessory Kit

G7163-68755				
Accessory Kit	Item	#	p/n	Description
	1	6	5043-1013	Tubing Clip
	2	2	5063-6527	Leak tubing assembly, 1 m
	3	1	5067-6837	Equipotential Cable
	4	1	5500-1155	Tube Connector, 90 degree, ID 6.4
	5	5	5043-1356	Colum Holder Lamella

Leak and Waste

- 1** Position the module correctly above the leak plane. Guide the tubing end correctly inside the leak plane.

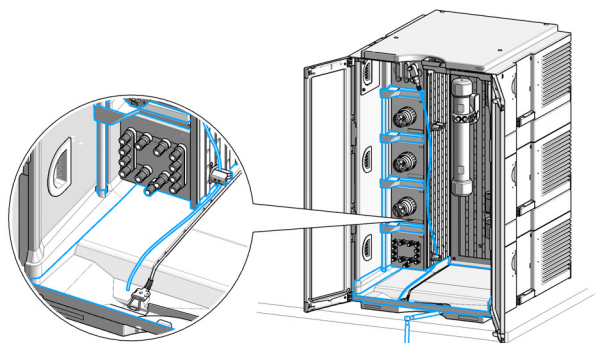

- 2** Guide the tubing from the module on top of the Preparative Column Compartment separately to waste (as shown).

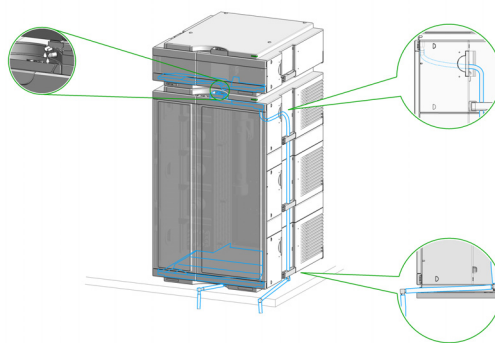

Install the Equipotential Cable

- 1 Install the equipotential cable between the Preparative Column Compartment and the pump.

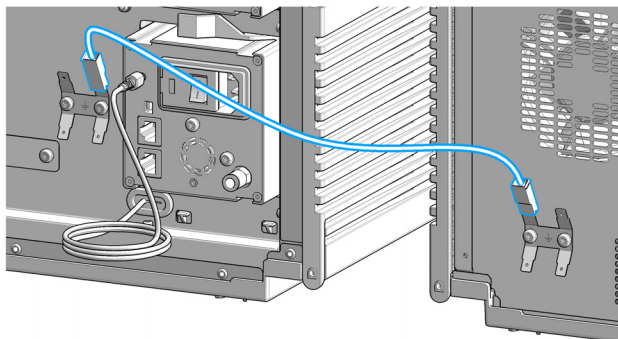

Install the Holder S (small)

The holder S (small) can be used to fix the pressure relief valve, the back pressure regulator, or to organize capillaries.

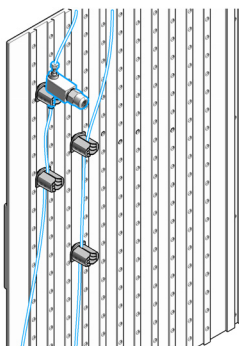

1 Insert the holder S into the mounting plate.

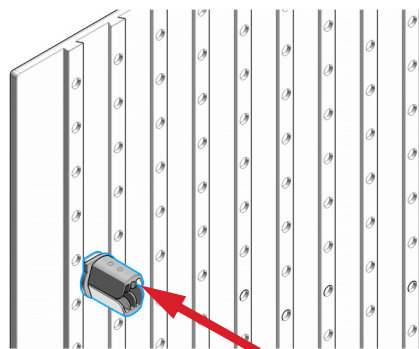

2 Twist the holder S 90 degrees until it stays in place.

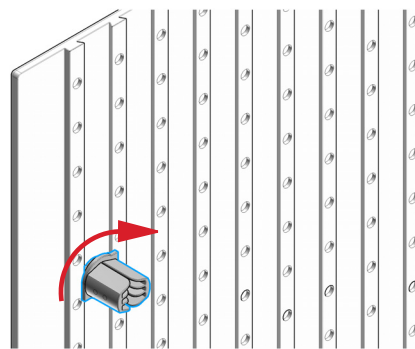

The holders S are fixed at the mounting plate.

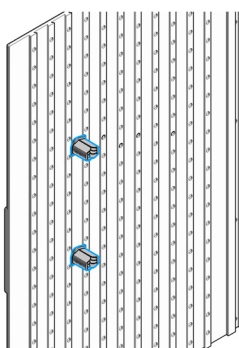

Installation

Install the Holder M (medium) and Clamp Assembly

Install the Holder M (medium) and Clamp Assembly

- 1** Squeeze the buttons left and right and lay on edge to insert the holder M into the mounting plate.

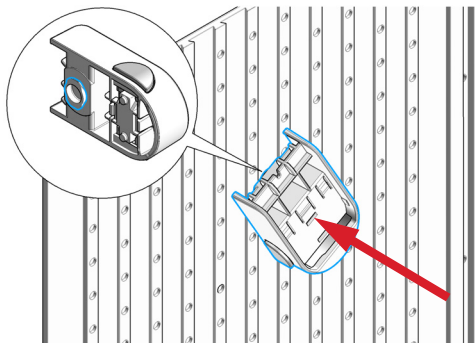

- 2** Release the left and right buttons while twisting the holder M by 90 degrees.

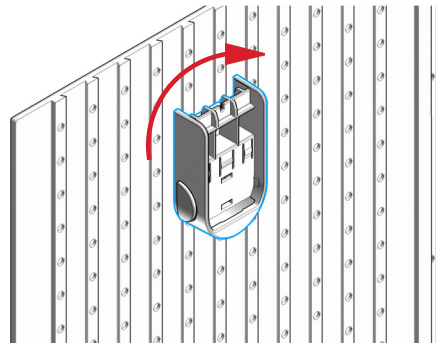

The holder M is fixed to the mounting plate.

- 3** Hook the clamp assembly onto the holder M.

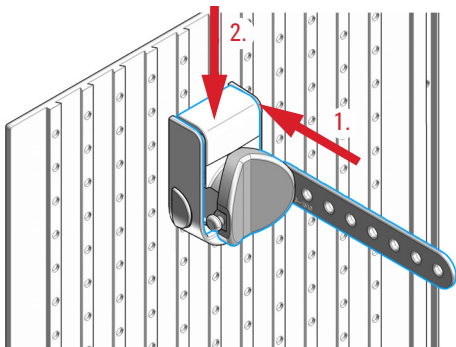

- 4** Position the column on the clamp assembly.

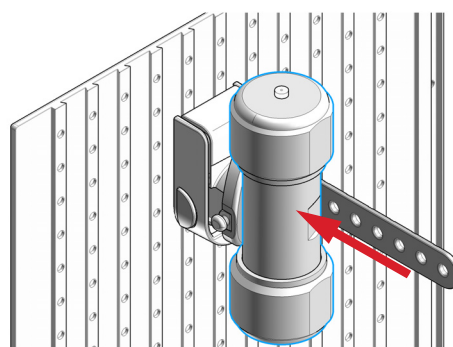

- 5** Use the silicone strip to fix the column to the clamp assembly.

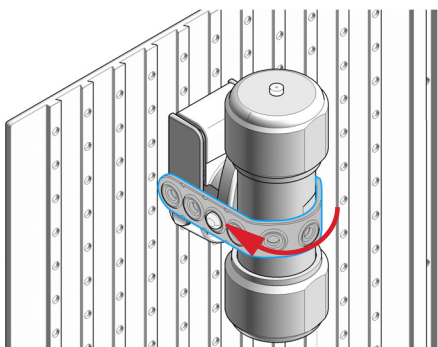

Install the Holder L (large)

Parts required	p/n	Description
	G7163-20007	Beltscrew
	5043-1465	Belt-long
	G7163-20005	Locking Bolt

- 1** Install Beltscrew (G7163-20007) to the appropriate belt positions on both sides of the holder.

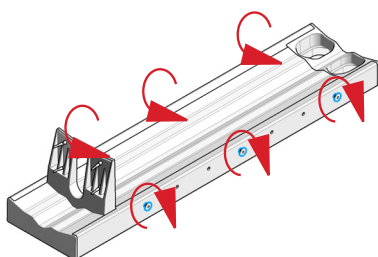

- 2** Install Belt-long (5043-1465) on the screws.

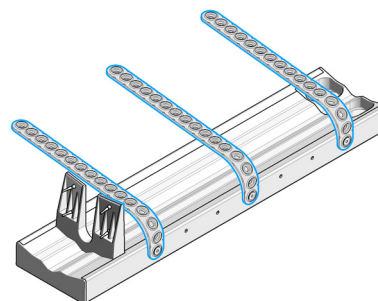

- 3** Use the rubber belts to fix the column to the holder.

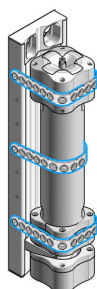

- 4** Install three Locking Bolt (G7163-20005) onto the mounting plate.

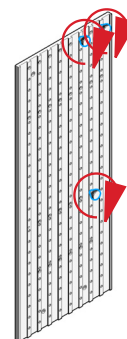

- 5** Hang the holder with the column on the mounting plate.

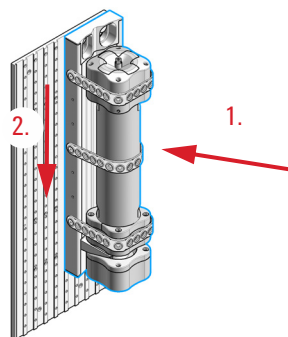

Install Valves

NOTE

Agilent does not support installing an 1260 Infinity II Fraction Collector Cluster Valve (G9322A) to the Preparative Column Compartment.

- 1** Slide the valve into one of the slots in the preparative column compartment.

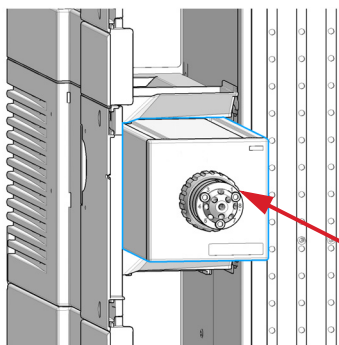

- 2** Slide the valve completely in until it stops at the end of the slot.

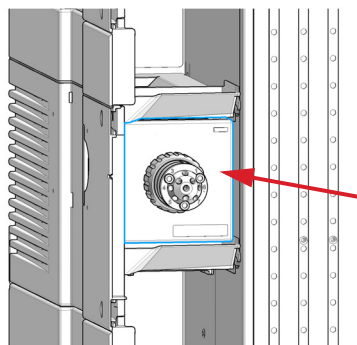

- 3** At the back of the column compartment, close the lever to fix the valve.

