



## Demo: Replace the Split Vent Trap

**Herb Brooks** is an Agilent service engineer.

The split vent trap should be replaced annually, at a minimum. If you are frequently analyzing dirty samples, you should replace it more often.

Before you start: load your maintenance method, allow the inlet oven to cool and depressurize the inlet.

Steps to replacing the split vent trap:

- 1) Remove the pneumatics cover (top, back of GC).
- 2) Completely loosen the 2 screws that hold down the split vent valve. Loosen the 1 screw that holds down the trap weldment.

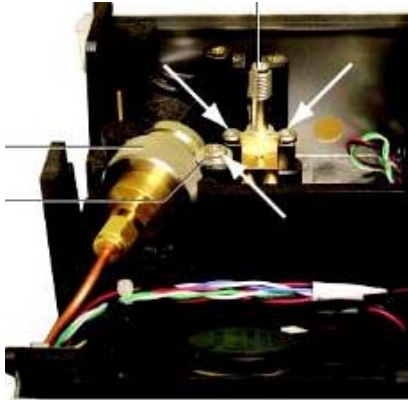

Rotate the retaining clip out of the way.

- 3) The trap is inside the weldment. Try to loosen the large knurled nut of the trap weldment by turning it counter-clockwise.



- 4) Lift the filter trap assembly and split vent valve from the mounting bracket together and unscrew the split vent front weldment on the filter trap assembly.

- 5) Next, open the weldment, remove the trap and 2 o-ring seals.

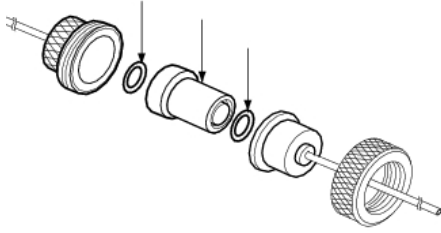

- 6) Seat the new o-rings on the new filter cartridge and insert into the weldment. Point the narrow end toward the back of the GC.
- 7) Start closing the weldment by threading the knurled ring onto the other side, but don't tighten the nut yet.
- 8) Place the filter trap assembly in the mounting bracket and install the retaining clip.
- 9) Reinstall the screws of the split vent valve and fully tighten the large knurled nut onto the trap.
- 10) Before reloading your analytical method, it is a good practice to turn on the inlet and allow the inlet and column to purge with carrier gas for 15 minutes.